

Tube Accessory Installation

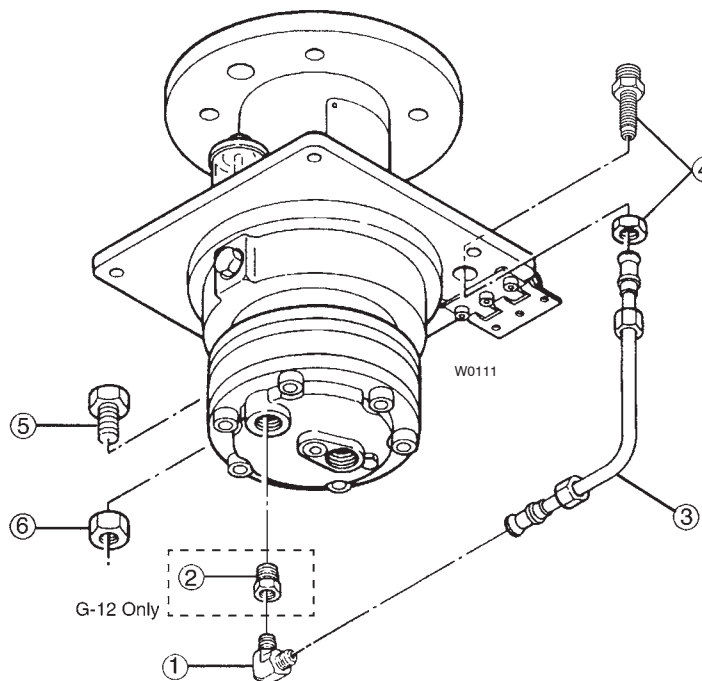

The Tube Accessory can be installed on either the right or left side of the pump housing.

Tube Accessory (PN A04-007-1200) is used on D-12 pumps with NPT threaded manifolds; (PN A04-009-1200) is used on G-12 pumps with BSPT threaded manifolds.

Refer to the pump Installation/Service Manual (Document D12-991-2400) for additional information on installing the pump into a tank when a Tube Accessory is included.

Assembly Instructions

1. Remove the lock nut from the bulkhead union (4). Insert the bulkhead union into the hole in the pump housing and loosely hand tighten the lock nut (three or four turns). **Do not tighten the lock nut until all tubes and fittings are aligned and secured in the following steps.**
2. Use pipe sealant on the threads of the elbow (1) [and bushing (2) on G-12 version], and tighten into the outlet port of the pump manifold. Align the elbow with the bulkhead union (4).
3. Finger tighten the tube assembly (3) to the elbow (1) and to the bulkhead union (4).
4. Firmly tighten the bulkhead union (4) lock nut to secure the complete tube assembly to the pump housing.
5. Firmly tighten the tube assembly (3) connections to the bulkhead union (4) and to the elbow (1).

NOTE: You may have to do steps 4 and 5 simultaneously to properly fit the tube assembly (3) between the flared ends of the union (4) and the elbow (1).

6. Install the bolt (5) through the empty hole in the housing, and firmly tighten the nut (6).

Ref No.	Part Number	Description	Qty
1	D12-112-2210	Elbow, 90°, flare, 3/4" NPT.....	1
	G12-112-2210	Elbow, 90°, flare, 1/2" BSPT	1
2	G12-122-2210	Bushing, reducer, 1/2" to 3/4" BSPT ...	1
3	D12-113-1210	Tube Assembly, pressure	1
4	D12-120-2210	Union, bulkhead, NPT, with nut	1
	G12-120-2210	Union, bulkhead, BSPT, with nut	1
5	D12-107-2010	Bolt, hex, 3/4" x 1-1/4"	1
6	D12-106-2010	Nut, hex, 3/4"	1



QUICK & DISCOUNTED PRICING
CLICK HERE
 OR CALL (908) 362-9981